



VALENTINO

Linear fire (balanced flue system)



BACK WALL FINISH

Black matte steel (standard)
Black ceramic glass (optional)

DECORATION

Logs, granules & chips
Black diamond stones
Pebbles & gold vermiculite

CONTROL OPTIONS



Thermostat



Modular burner



Gas and CO detectors



Antireflective glass

VALENTINO

| | 1000 mm 39.4" | 1300 mm 51.2" |
|--|---|--|
| | (NG) max. 6.4 kW 21 837 BTU/h (LPG) max. 6.7 kW 22 861 BTU/h | (NG) max. 8.5 kW 29 003 BTU/h (LPG) max. 7.4 kW 25 250 BTU/h |
| | (NG) max. 0.9 m ³ /h 31.8 ft ³ /h (LPG) max. 0.7 kg/h 1.54 lbs/h | (NG) max. 1.2 m ³ /h 42.4 ft ³ /h (LPG) max. 0.78 kg/h 1.72 lbs/h |
| | Concentric flue 200/130 | |
| | 230 V / [US] 115 V | |



FRONT



LEFT FRONT



RIGHT FRONT



LEFT FRONT RIGHT

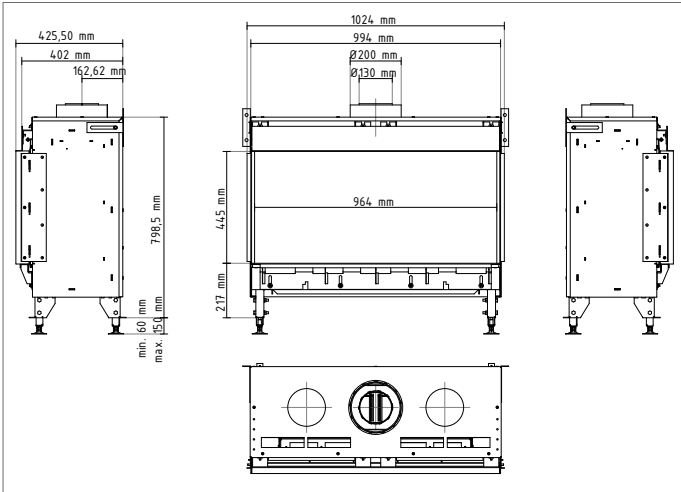

VALENTINO 1000

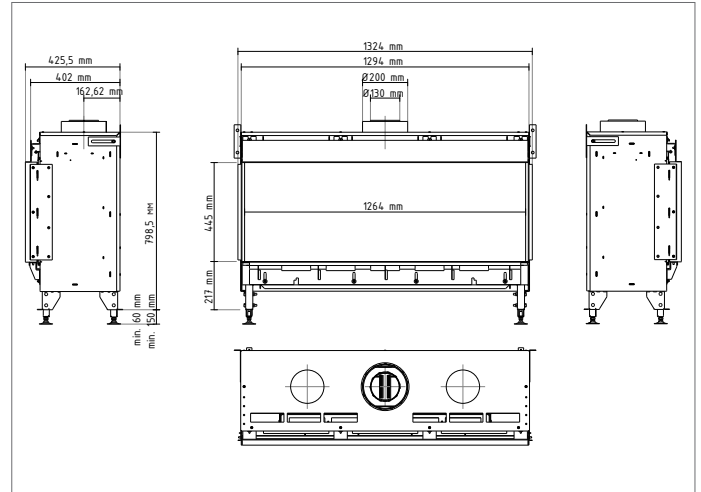

VALENTINO 1300

VALENTINO LEFT FRONT / RIGHT FRONT

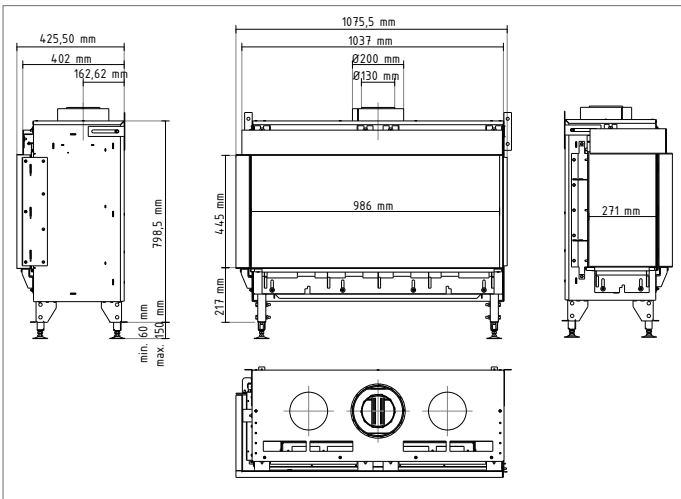

VALENTINO 1000

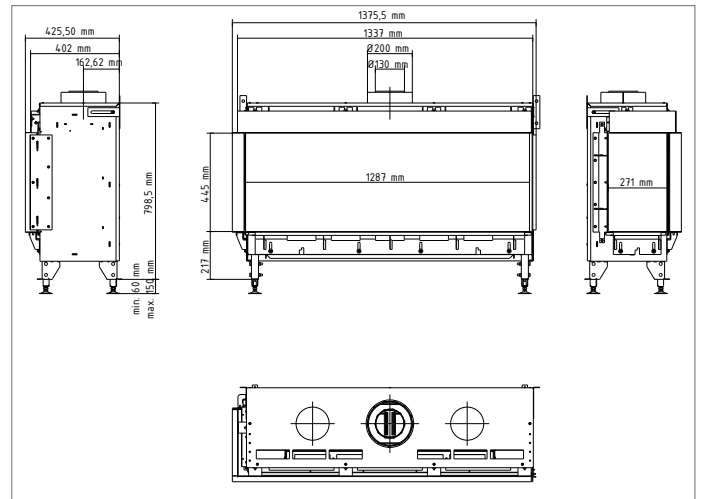

VALENTINO 1300

VALENTINO LEFT FRONT RIGHT

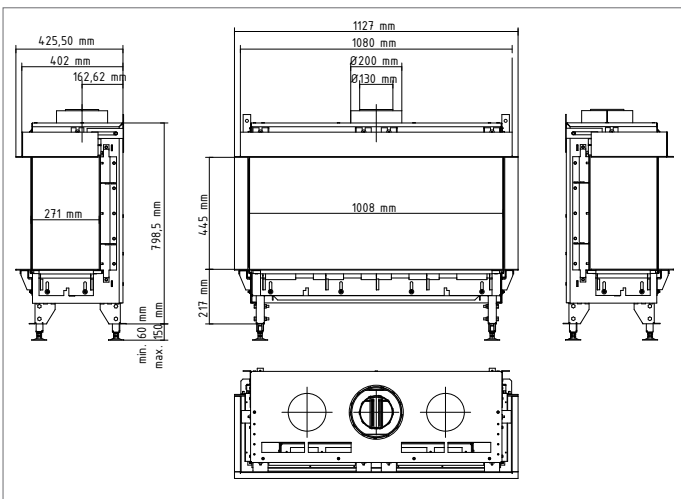

VALENTINO 1000

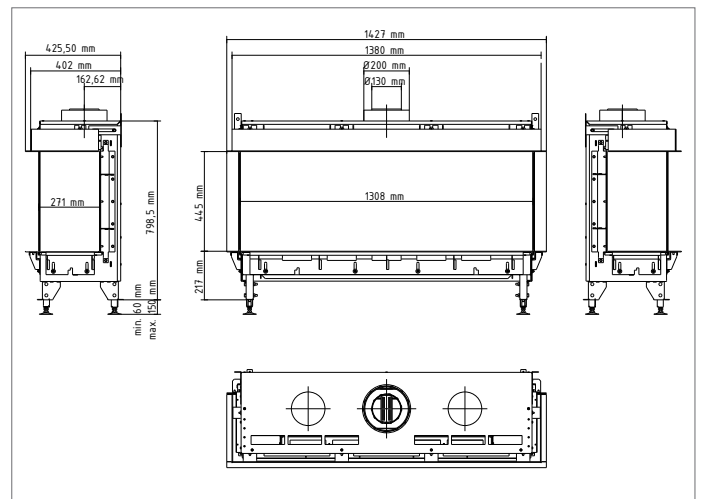

VALENTINO 1300